

TUBULAR DEADBOLTS AND CYLINDRICAL DEADLATCHES **A-1**

A500 Series Tubular Deadbolt
Grade 1

A560 Single Cylinder

A561 Communicating

A562 Double Cylinder

A563 Classroom

Specifications

- Meets ANSI 156.5 Grade 1
- Grade 1 Cylindrical Chassis
- Grade 1 Latchbolt 9/16”(14.2mm) x 1-1/8”(29mm) Strike
- Strike 2-3/4”(70mm) x 1-1/8”(29mm)
- Latch Face 1”(25.4mm) x 2-1/4”(57mm)
- Door Thickness From 1-3/8”(35mm) - 1-7/8”(48mm)
- Available in 605, 606, 610, 613, 626, 629, 630



A560
(E0151)

Single
Cylinder
Deadbolt

- Key From Outside Retracts or Projects Deadbolt
- Thumbturn From Inside Retracts or Projects Deadbolt

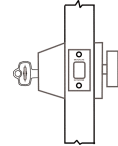

A561
(E0161)

Communicating
Deadbolt

- Key From Outside Retracts or Projects Deadbolt
- Blank Plate From Inside

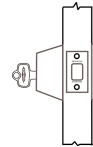

A562
(E0141)

Double
Cylinder
Deadbolt

- Key From Either Side Retracts or Projects Deadbolt

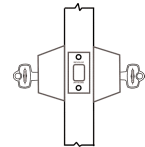

A563
(E0171)

Classroom
Deadbolt

- Key From Outside Retracts or Projects Deadbolt
- Thumbturn From Inside Retracts Deadbolt

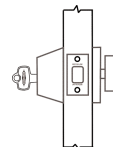

A600 Series Mortise Deadbolt
Grade 1

Specifications

- 2-3/4"(70mm) Backset
- 1"(25.4mm) Stainless Steel Bolt with Hardened Roll Pin
- Faceplate 1-1/16"(27mm) x 4-5/8"(92mm)
- Strike 1-1/8"(28.6mm) x 3-1/8"(mm)
- Latch Face 1-1/8"(28.6mm) x 2-1/4"(75mm)
- Door Thickness 1-3/4"(70mm)
- Accepts Standard Mortise Cylinder
- Available in 605, 606, 610, 613, 626, 629, 630

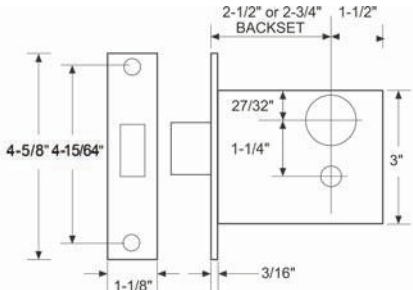

A660 Single Cylinder

A661 Communicating

A662 Double Cylinder

A663 Classroom

A660 (E06071) Single Cylinder Deadlatch
 • Key From Outside Retracts or Projects Deadbolt
 • Thumbturn From Inside Retracts or Projects Deadbolt

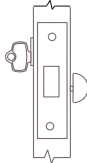

A661 (E06081) Communicating Deadlatch
 • Key From Outside Retracts or Projects Deadbolt
 • Blank From Inside

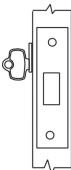

A662 (E06061) Double Cylinder Deadlatch
 • Key From Either Side Retracts or Projects Deadbolt

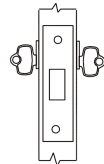

A663 (E06091) Single Cylinder Classroom Deadbolt
 • Key From Outside Retracts or Projects Deadbolt
 • Thumbturn From Inside Retracts Deadbolt

